

FEATURES

- Compatible with leading and trailing edge phase cut dimmers.
- 3-year guarantee.

Technical Data

Input Voltage/Hz	AC200-240V 50/60Hz
Output Voltage/Current	DC22V/330mA
Power	10W
Rated Input Current	0.05A
PF value	>0.9
Ingress Protection	IP54
Operating Temperature	-10-40°C
Dimmability	Triac dimmable with DIMMATE driver

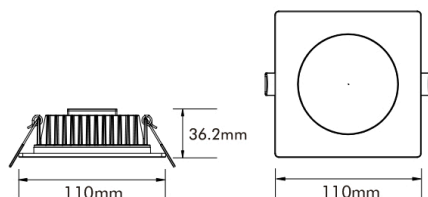

Cut-out: Ø90mm-100mm

Optical Data

LED Brand	Bridgelux SMD LED
CRI	Ra > 80
Colour temperature	2700K/3000K/4000K/5000K
System luminous efficacy up to	72lm/W

Packaging

Box Dimensions	L115 x W115 x H95mm
Box Net Weight	0.288Kg
Box Gross Weight	0.338Kg
Carton Dimensions	L480 x W420 x H310 mm/36 PCS
Carton Net Weight	10.37Kg
Carton Gross Weight	12.97Kg



Model	CCT		Beam Angle	Lumen	Efficacy
DL44-10-XX-09	2700K	CRI 80+	100°	642lm	72lm/W
DL44-10-XX-09	3000K		100°	633lm	68lm/W
DL44-10-XX-09	4000K		100°	668lm	72lm/W
DL44-10-XX-09	5000K		100°	660lm	70lm/W

ECLIPSE CONSEIL

Siège : +33 (1) 79 30 48 19- Showroom Paris : +33 (1) 78 95 50 14 - Mob : +33 (6) 87 82 12 04
Siège social : 7 rue Prudent Neel 92500 Rueil-Malmaison - Showroom : 1 rue Dulong 75017 PARIS